



INSTRUCTION BULLETIN

No. 340098
Machine: 800/810
Published: 10-97/00
System: CHASSIS

NOTE: DO NOT DISCARD the Parts List from the Instruction Bulletin. Place the Parts List in the appropriate place in your machine manual for future reference. Retaining the Parts List will make it easier to reorder individual parts and will save you the cost of ordering an entire kit.

NOTE: Numbers in parenthesis () are reference numbers for parts listed in Bill of Materials.

Installation Instructions for Kit number 380751

SYNOPSIS / PROBLEM:

This kit contains the parts needed to replace the propel cable pump bracket on the model 800/810 sweeper. Please follow step-by-step instructions.

SPECIAL TOOLS / CONSIDERATIONS: None

(Estimated time to complete: 2 hours)

INSTALLATION:

(Refer to FIG. 1 and 2)

FOR SAFETY: Before leaving or servicing machine, stop on level surface and set parking brake. Then turn off machine and remove key.

1. Open the engine cover and side door.
2. Disconnect the battery cables.
3. Raise the rear of the machine and install jack stands under the frame.
4. If your machine is equipped with the back-up alarm option-- Remove the small roller switch from the mount bracket near the accessory pump. Retain the switch and hardware.
(Refer to FIG. 1)

NOTE: Make sure to mark the propel cable, jam nuts, and ball joint location before removal.

This will allow re-assembly of the cable without changing the propel adjustments.

(Refer to FIG. 1)

5. Remove the nut from the propel cable ball joint where it attaches to the propel pump control arm. (Refer to FIG. 1)
6. Loosen the two large jam nuts on the propel cable where it attaches to the mount bracket at the accessory pump mount flange. Pull the propel cable out of the slot and pump control arm and place it out of the way for now. (Refer to FIG. 1)
7. Remove the two hex screws holding the propel cable mount bracket to the accessory pump mount flange. Remove and discard the existing cable mount bracket. Retain the hardware. (Refer to FIG. 1)
8. Install the new cable mount bracket (1) on the accessory pump mount flange. Re-use the hardware and tighten to 15 - 20 ft lbs. (Refer to FIG. 2)

9. Install the new cable propel bracket (2) on the pump control arm using the two screws (3) and two nuts (4). Tighten to 7 - 10 ft lbs. (Refer to FIG. 2)
10. Install the propel cable ball joint in the mount hole in the new bracket (2). Reinstall the nyloc nut and tighten to 7 - 10 ft lbs. (Refer to FIG. 2)
11. Install the propel cable into the mount slot on the new bracket (1). Tighten the two jam nuts tight. (Refer to FIG. 2)

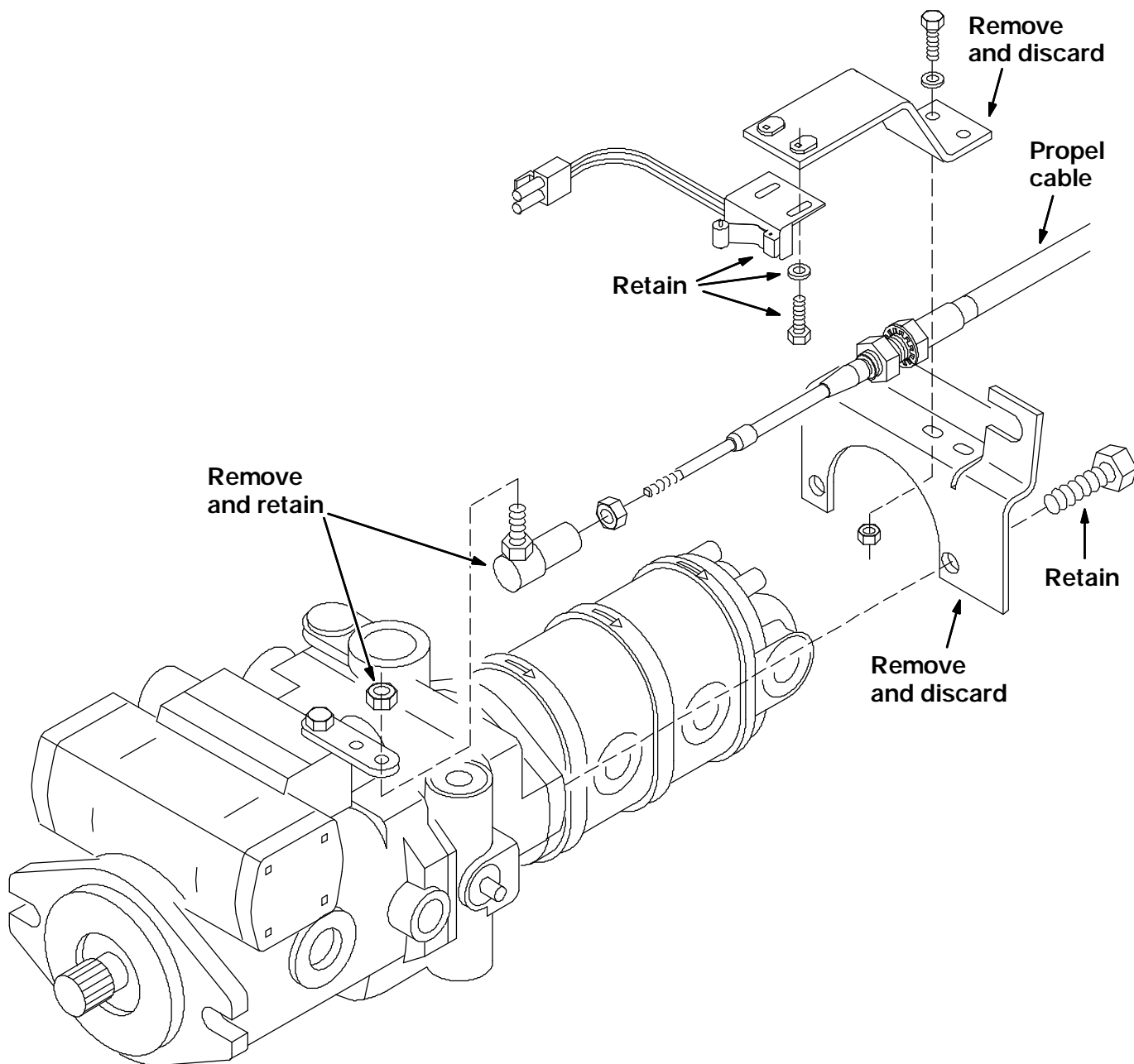

FIG. 1 - Existing Propel Cable Mount Bracket, Back-up Alarm Switch And Mount Bracket

12. If your machine is equipped with the back-up alarm option--Install the roller switch on the upper bracket on the new cable mount bracket (1). Re-use the hardware removed from the old bracket. Hand tighten tight. (Refer to FIG. 2)
13. Reconnect the battery and start the machine. Check the rear tire for any movement. Adjust the centering if necessary.

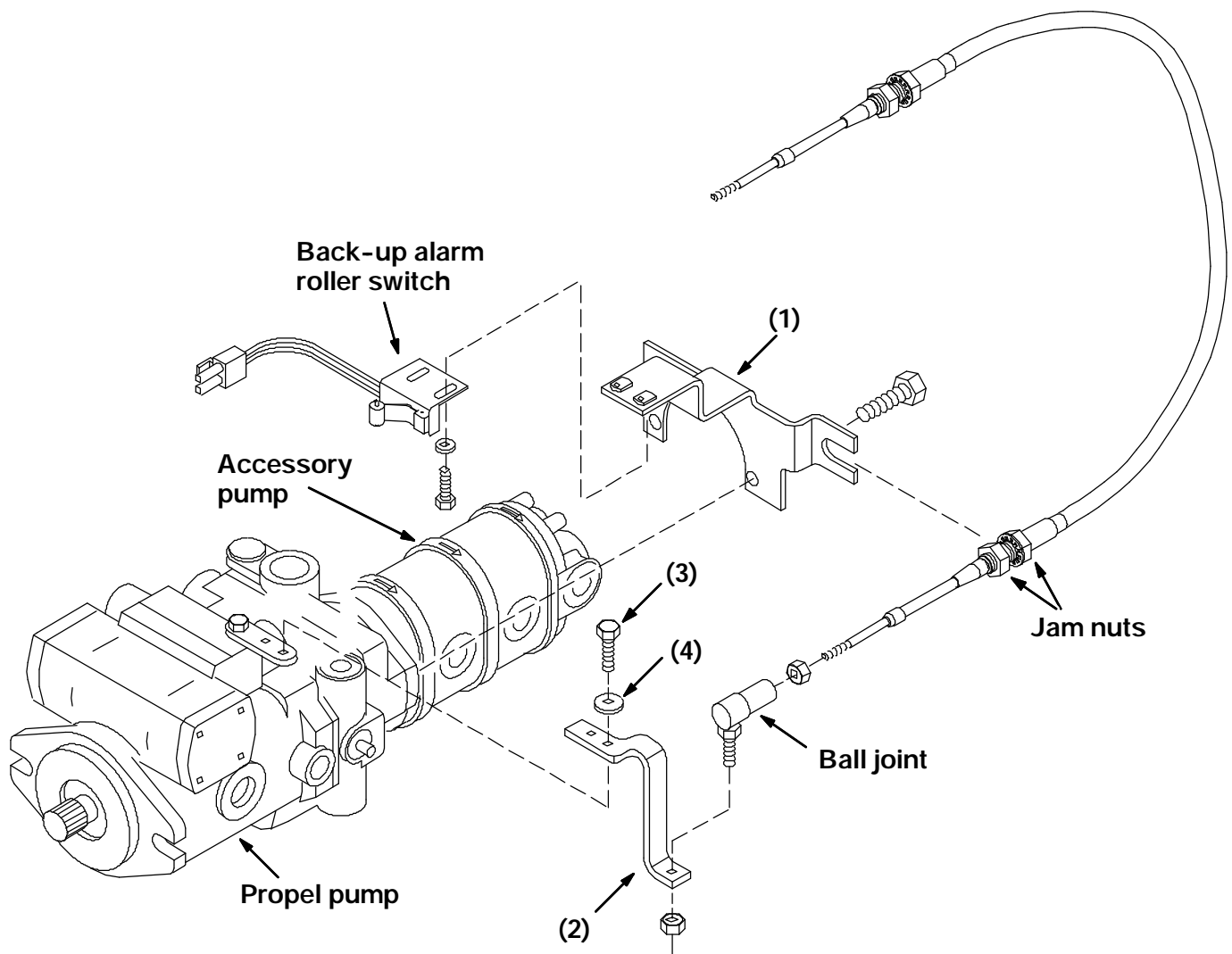

FIG. 2 - New Propel Cable Mount Bracket And Directional Lever

BILL OF MATERIALS FOR BRACKET REPLACEMENT KIT 380751

Ref.	TENNANT Part No.	Description	Qty.
1	380513	Cable mount bracket	1
2	380514	Cable mount propel bracket	1
3	06944	Hex screw, M6 x 25mm	2
4	08708	Nyloc nut, M6	2

TENNANT COMPANY
P. O. Box 1452
Minneapolis, MN 55440-1452